



AMBER WALL MOUNT

L70
 25°C 89,000 Hours



Shown with "B" Wide Optic



Shown with "A" Medium Optic



Shown with "D" Narrow Optic

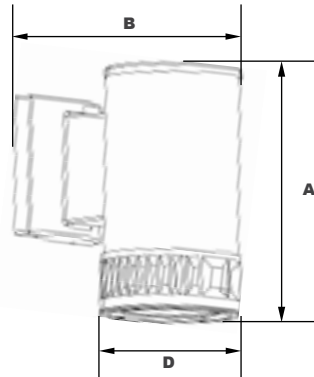

Dimensions

| | |
|---------------------|-----------------|
| Diameter (D) | 5 7/8" (146mm) |
| Length (B) | 8 7/8" (226mm) |
| Height (A) | 10 1/4" (260mm) |

Pemco's AmberLED Compass Up or Down architectural wall cylinder provides up or down lighting with narrow, medium and wide distributions designed to replace HID lighting systems from up to 100w MH or HPS for wildlife or security applications requiring monochromatic AMBER light. LEDs operate between 585 and 595nm, greater than 560nm required for wildlife protection. Typical wall mounted lighting applications include retail centers, industrial parks, schools and universities, public transit and airports, office buildings and medical facilities. Mounting heights of up to 12 feet can be used based on light level and uniformity requirements.

Specifications and Features:

Housing:

Extruded Round Aluminum Housing with Built-in Heat Sinks.

Listing & Ratings:

CSA: Listed for Wet Locations, ANSI/UL 1598, 8750; IP66 Sealed LED Compartment.

Finish:

Textured Architectural Bronze or Black Powdercoat Finish Over a Chromate Conversion Coating. Custom Colors Available Upon Request.

Lens:

Tempered Clear Flat Glass Lens

Reflector:

Wide, Medium and Narrow Distributions

Mounting Options:

Mount Over a 4" Recessed Outlet Box.

COB LED:

Amber COB

Wattage:

COB: 20w, System: 21w; (100w HID Equivalent)

Driver:

Electronic Driver, 120-277V, 50/60Hz; Less Than 20% THD and PF>0.90. Standard Internal Surge Protection 2kV. 0-10V Dimming Standard for a Dimming Range of 100% to 10%; Dimming Source Current is 150 Microamps.

Controls:

Fixtures Ordered with Factory-Installed Photocell or Motion Sensor Controls are Internally Wired for Switching and/or 1-10V Dimming Within the Housing. Remote Direct Wired Interface of 1-10V Dimming is Not Implied and May Not Be Available. Please Consult Factory. Fixtures are Tested with LEPG Controls and May Not Function Properly With Controls Supplied By Others. Fixtures are NOT Designed for Use with Line Voltage Dimmers.

Warranty:

5-Year Warranty for -40°C to +50°C Environment.

See Page 2 for Projected Lumen Maintenance Table.

AmberLED

ORDERING FORMAT

Example: CMPRSAC31X20UAMZSP

| CMPRS | | C3 | 1X20 | U | AM | | |
|-------------------------------------|--|--------|----------|------------|----------|---|---|
| Model | Optics | LED | Wattage | Driver | CCT | Color | Options |
| CMPRS= LED Up or Down Wall Cylinder | A=70° Reflector B=100° Reflector D=30° Reflector | C3=COB | 1X20=20w | U=120-277V | AM=Amber | Z=Bronze B=Black C=Custom (Consult Factory) | SF=Single Fuse* DF=Double Fuse* SP=Surge Protection PC3=Photocell, 120VAC BU=Battery Backup, 90 Minutes* *120-277V Models Only |





AMBER WALL MOUNT

Accessories & Replacement Parts:

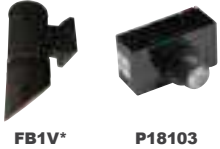

| Accessories (Order Separately, Field Installed) | |
|---|--|
| FB1V* | Visor, Aluminum with Powdercoat Finish |
| *Specify Color: Z=Bronze, B=Black, C=Custom (Consult Factory) | |

| Replacement Parts (Order Separately, Field Installed) | |
|--|----------------------|
| P18103 | 120-277VAC Photocell |
| For Replacement Battery Backup, see the LEPG LED Battery Backup Specification Sheet. | |

*Shown Mounted

Photometric Data

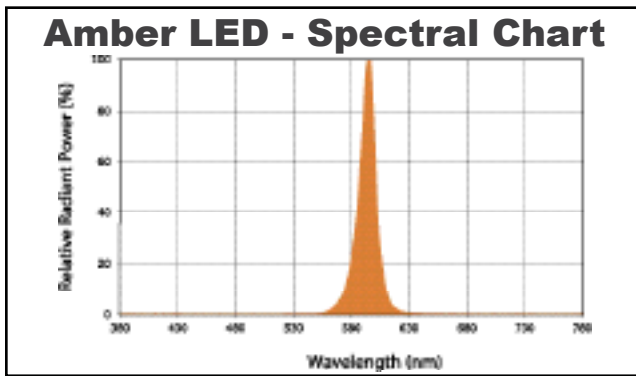

Photometric Performance

| LED Board Watts | Drive Current (mA) | Input Watts | Beam | |
|-----------------|--------------------|-------------|------|--------|
| | | | | |
| LED COB 20w | 525 | 21 | A | Medium |
| | | | B | Wide |
| | | | D | Narrow |

Projected Lumen Maintenance

| Data shown for 4100 CCT | Compare to MH | | | | | | |
|--------------------------------------|---------------|-------------|------------|------------|-------------|----------------------|----------------------|
| | TM-21-11 | Input Watts | Initial | 25,000 Hrs | 50,000 Hrs | 100,000 Hrs | Calculated L70@ 25°C |
| L70 Lumen Maintenance @ 25°C / 77°F | 21 | 1.00 | 0.92 | 0.83 | 0.66 | | 89,000 |
| TM-21-11 | Input Watts | Initial | 25,000 Hrs | 50,000 Hrs | 100,000 Hrs | Calculated L70@ 50°C | |
| L70 Lumen Maintenance @ 50°C / 122°F | 21 | 1.00 | 0.90 | 0.81 | 0.62 | | 78,000 |
| TM-21-11 | Input Watts | Initial | 25,000 Hrs | 50,000 Hrs | 100,000 Hrs | Calculated L80@ 40°C | |
| L80 Lumen Maintenance @ 40°C / 104°F | 21 | 1.00 | 0.93 | 0.86 | 0.72 | | 72,000 |

NOTES:

1. Projected per IESNA TM-21-11. Data references the extrapolated performance projections for the 525mA base model in a 25°C ambient, based on 10,000 hours of LED testing per IESNA LM-80-08.
2. Compare to MH box indicates suggested Light Loss Factor (LLF) to be used when comparing to Metal Halide (MH) systems.