



**LOW PROFILE LED
 PATHWAY BOLLARDS**

L70
 25°C 106,000 Hours



**PNB1Q - Round Low Profile
 Pathway Bollard**



PNB2Q - Square Low Profile Pathway Bollard

Dimensions

Width (B)	9 1/4" (234mm)
Diameter (D)	7" (180mm)
Height (A)	10" (254mm)

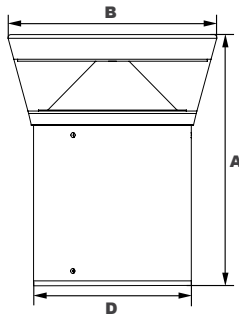

1882 Lighting's PNB1Q and PNB2Q EasyLED Low Profile Pathway Bollards with UV-stabilized polycarbonate lenses and sealed optical compartments are designed to replace incandescent and halogen pathway lighting. These fixtures are ideal for retail centers, parks, schools and universities, public transit and airports, office buildings and medical facilities.

Specifications and Features:

Housing:

Extruded Aluminum Housing with Flush Mounting Base & Vandal-Resistant Screws, Flat Top, Internal Driver Tray for Easy Maintenance.

Listing & Ratings:

CSA: Listed for Wet Locations, ANSI/UL 1598, 8750
 IP66 Sealed LED Compartment.

Finish:

Textured Architectural Bronze or Black Powdercoat Finish Over a Chromate Conversion Coating. Custom Colors Available Upon Request.

Reflector:

Reflective White UV-Stabilized Polycarbonate Cone Reflector

Lens:

Clear UV-Stabilized Polycarbonate or SoftLED LumaLens Opal UV-Stabilized Polycarbonate Vandal-Resistant Lens

Mounting Options:

Mounting Kit with 8" Anchor Bolts, Included.

EasyLED LED:

Aluminum Boards

Wattage:

Array: 16w, System: 17.7w (up to 70w HID equivalent)
 Array: 23w, System: 24.8w (up to 70w HID equivalent)
 Array: 34w, System: 37.2w (up to 70w HID equivalent)

Driver:

Electronic Driver, 120-277V, 50/60Hz or 347V, 50/60Hz; Less Than 20% THD and PF>0.90. Standard Internal Surge Protection 2kV. 0-10V Dimming Standard for a Dimming Range of 100% to 10%; Dimming Source Current is 150 Microamps.

Warranty:

5-Year Warranty for -20°C to +40°C Environment.

See Page 3 for Projected Lumen Maintenance Table.





LOW PROFILE LED PATHWAY BOLLARDS

Order Information Example: PNB1QF1X34U4KCZ10SF

Model	Optics	Wattage	Driver	CCT	Lens	Color	Height	Options
PNB1Q = EasyLED Round Low Profile Pathway Bollard PNB2Q = EasyLED Square Low Profile Pathway Bollard	F =Wide Beam Spread	1X16 =16w 1X23 =23w 1X34 =34w	U =120-277V C =347V* H =1347-480V* *23w Model Only *34w Model Only	3K =3000K 4K =4000K	C =Clear UV-Stabilized Polycarbonate Array Lens L =SoftLED LumaLens Opal UV-Stabilized Polycarbonate Lens	Z =Bronze B =Black C =Custom (Consult Factory)	10 =10" Height C =Custom* *Consult factory. Minimum NEC requirements for wiring space and above ground level must be met.	SF =Single Fuse* DF =Double Fuse* SP =Surge Protection *120-277V Only

Accessories & Replacement Parts:

Mounting Accessories (Order Separately, Field Installed)

- BOLAN4 Mounting Kit, Includes Bracket & Three 4" Anchor Bolts
- BOLAN8 Mounting Kit, Includes Bracket & Three 8" Anchor Bolts
- BOLAN12 Mounting Kit, Includes Bracket & Three 12" Anchor Bolts
- BOLAN15 Mounting Kit, Includes Bracket & Three 15" Anchor Bolts

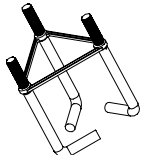

BOLAN

Replacement Parts (Order Separately, Field Installed)

- BORBASE* Die Cast Base Plate with Powdercoat Finish Over a Chromate Conversion Coating. Fits PNB1Q.
- BOSBASE* Die Cast Base Plate with Powdercoat Finish Over a Chromate Conversion Coating. Fits PNB2Q.

*Specify Color: Z=Bronze, B=Black, C=Custom (Consult Factory)

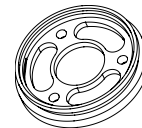

BORBASE

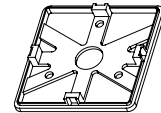

BOSBASE

Photometric Data

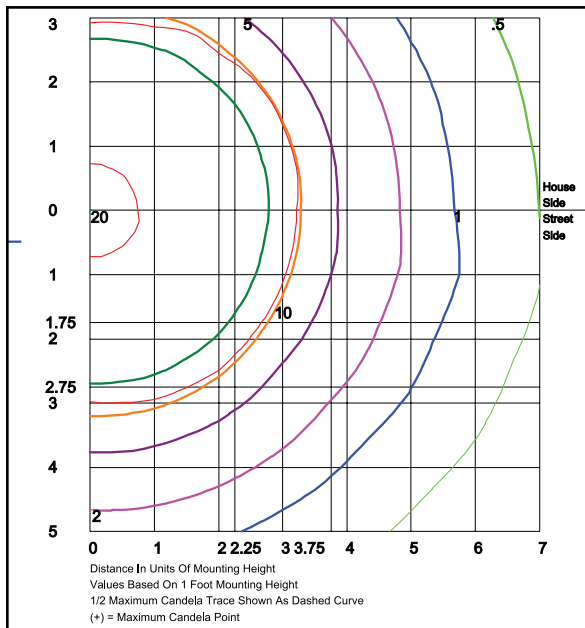



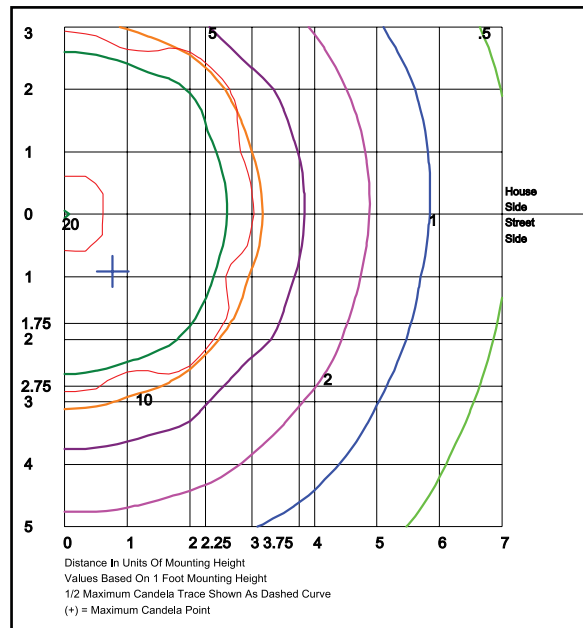

PNB1QF1X34U4KC
Grid in feet, Mounting Height=1ft.



PNB2QF1X34U4KC
Grid in feet, Mounting Height=1ft.

Photometric Performance

Optic	Wattage (Catalog Logic)	16W (1X16)	23W (1X23)	34W (1X34)
	Input Watts	17.7W	24.8W	37.2W
Optic	CCT	Delivered Lumens		
	PNB1Q with Clear Polycarbonate F=Type V Optic	3000K	1,406	1,968
4000K		1,525	2,135	3,202
BUG Rating		B1-U3-G1	B1-U3-G1	B1-U3-G1
PNB1Q with LumaLens F=Type V Optic	3000K	899	1,258	1,888
	4000K	975	1,365	2,047
	BUG Rating	B1-U3-G1	B1-U3-G1	B1-U4-G2

Optic	Wattage (Catalog Logic)	16W (1X16)	23W (1X23)	34W (1X34)
	Input Watts	17.7W	24.8W	37.2W
Optic	CCT	Delivered Lumens		
	PNB2Q with Clear Polycarbonate F=Type V Optic	3000K	1,432	2,005
4000K		1,554	2,175	3,263
BUG Rating		B1-U3-G1	B1-U3-G1	B1-U4-G2
PNB2Q with LumaLens F=Type V Optic	3000K	864	1,210	1,816
	4000K	938	1,313	1,969
	BUG Rating	B1-U3-G1	B1-U3-G1	B1-U4-G2

Projected Lumen Maintenance

Data shown for 4000 CCT TM-21-11	Input Watts	Compare to MH				Calculated L70@ 25°C
		Initial	25,000 Hrs	50,000 Hrs	100,000 Hrs	
PNB1Q/PNB2Q L70 Lumen Maintenance @ 25°C / 77°F	All wattages up to and including 34w	1.00	0.96	0.92	0.84	187,000
PNB1Q/PNB2Q L70 Lumen Maintenance @ 50°C / 122°F		1.00	0.93	0.87	0.73	113,000
PNB1Q/PNB2Q L80 Lumen Maintenance @ 40°C / 104°F		1.00	0.97	0.93	0.86	144,000

NOTES:

1. Projected per IESNA TM-21-11. Data references the extrapolated performance projections for the base model in a 25°C ambient, based on 10,000 hours of LED testing per IESNA LM-80-08.
2. Compare to MH box indicates suggested Light Loss Factor (LLF) to be used when comparing to Metal Halide (MH) systems.